

PROVIDE FOUNDRY  
NAME AND FLOW  
DIRECTION AS SHOWN  
IN 1/2"± LETTERS

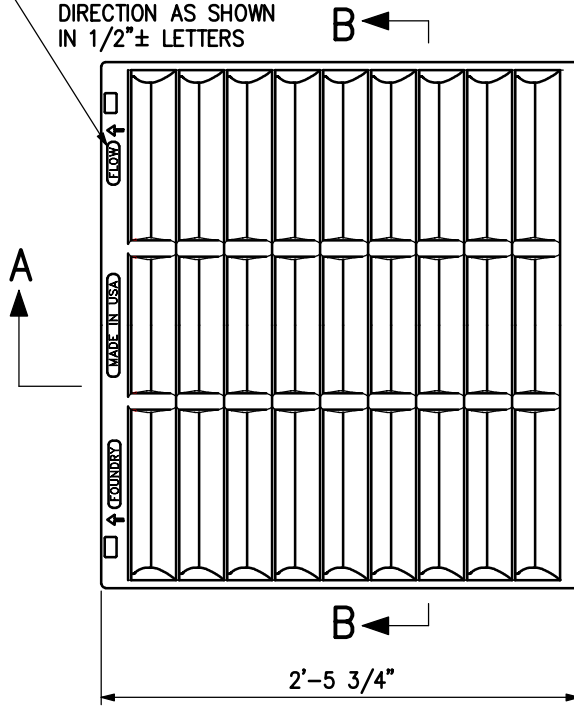

PLAN

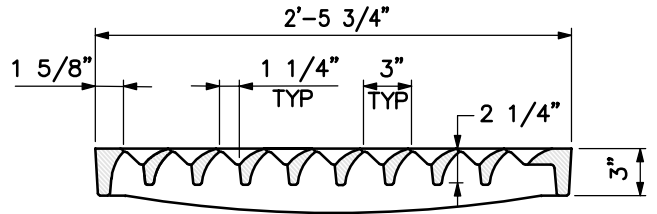

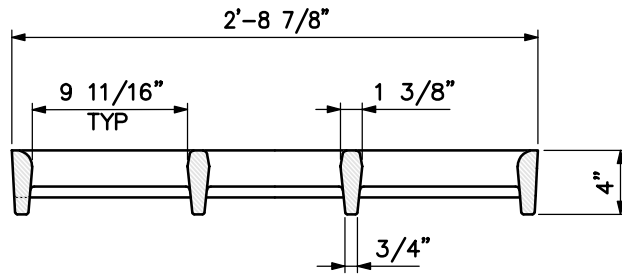

SECTION A-A



SECTION B-B

**NOTES:**

1. GRATE(S) SHALL SIT SQUARE UPON FRAME SUPPORTS WITHOUT ROCKING OR SHIFTING UNDER LOAD. GRATE SHALL MEET OR EXCEED AASHTO M306 PROOF LOAD REQUIREMENTS.
2. MATERIAL: GRAY IRON CASTING AASHTO DESIGNATION M105-06
3. WEIGHT: GRATE APPROXIMATELY 308 LBS.

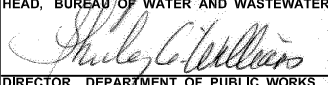
	APPROVED: 	CITY OF BALTIMORE DEPARTMENT OF PUBLIC WORKS BUREAU OF WATER AND WASTEWATER	ISSUED	REVISED	REVISED
	HEAD, BUREAU OF WATER AND WASTEWATER 		3 / 2008		
CURVED VANE (S-CV) GRATE(S) FOR EXISTING TYPE 'S' FRAME			<b>STANDARD NO.</b> <b>BC 380.07</b>		
			SCALE: NONE	SHEET 1 OF 1	